

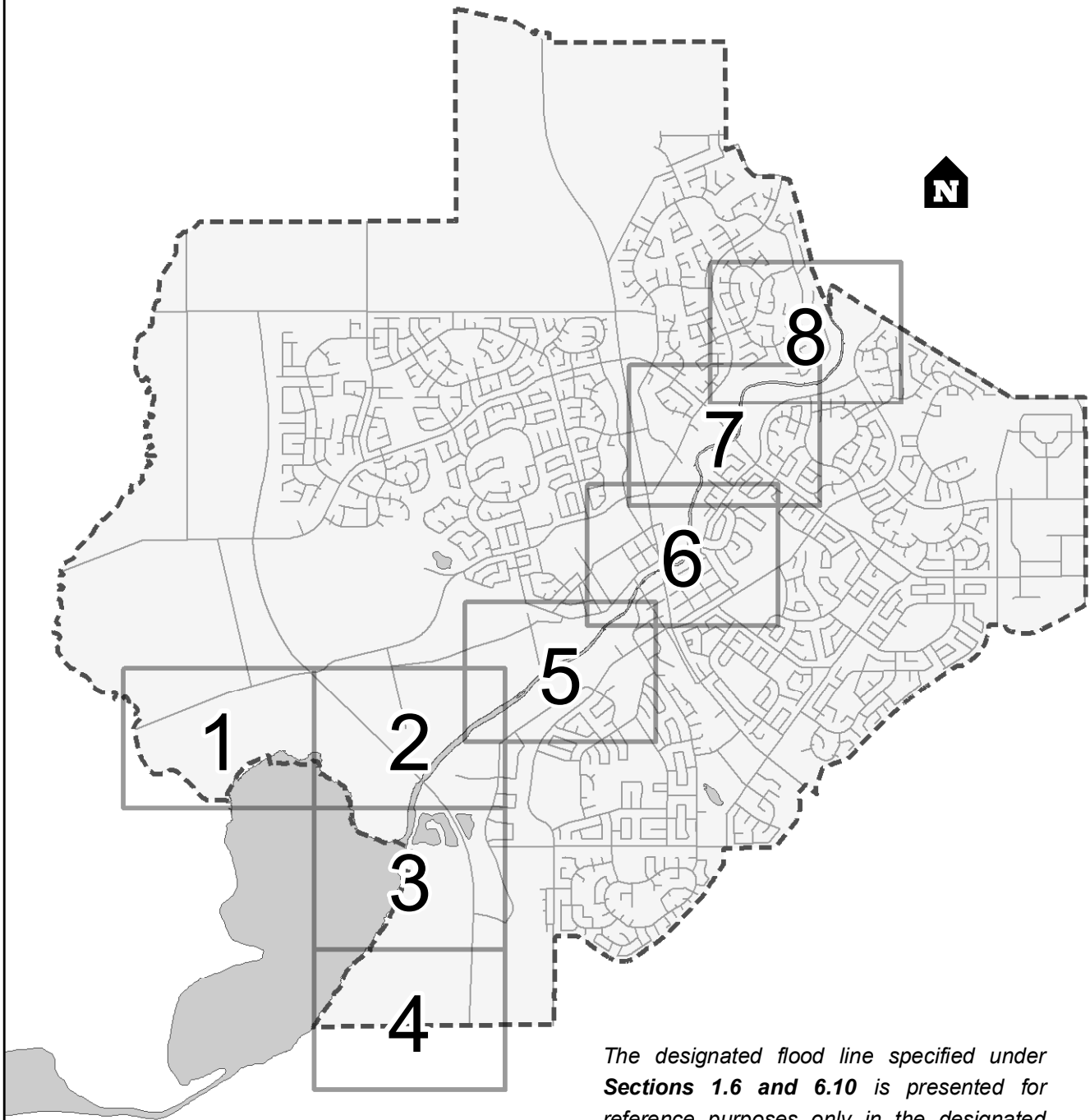



# Designated Flood Line Map

## MAP INDEX



### LEGEND

-  Cross-Sections [see 6.10(1)]
-  Designated Flood Line
-  City Boundary
-  Permitted Fill Area

*The designated flood line specified under Sections 1.6 and 6.10 is presented for reference purposes only in the designated flood line map, which is Schedule G of the Bylaw. The depicted flood line has been generalized for presentation purposes and is not guaranteed for accuracy.*

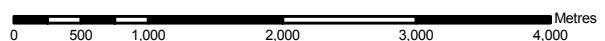

G:\MAPS\FloodMapping\2011\Schedule\_G\MAP-00-Flood\_Index.mxd

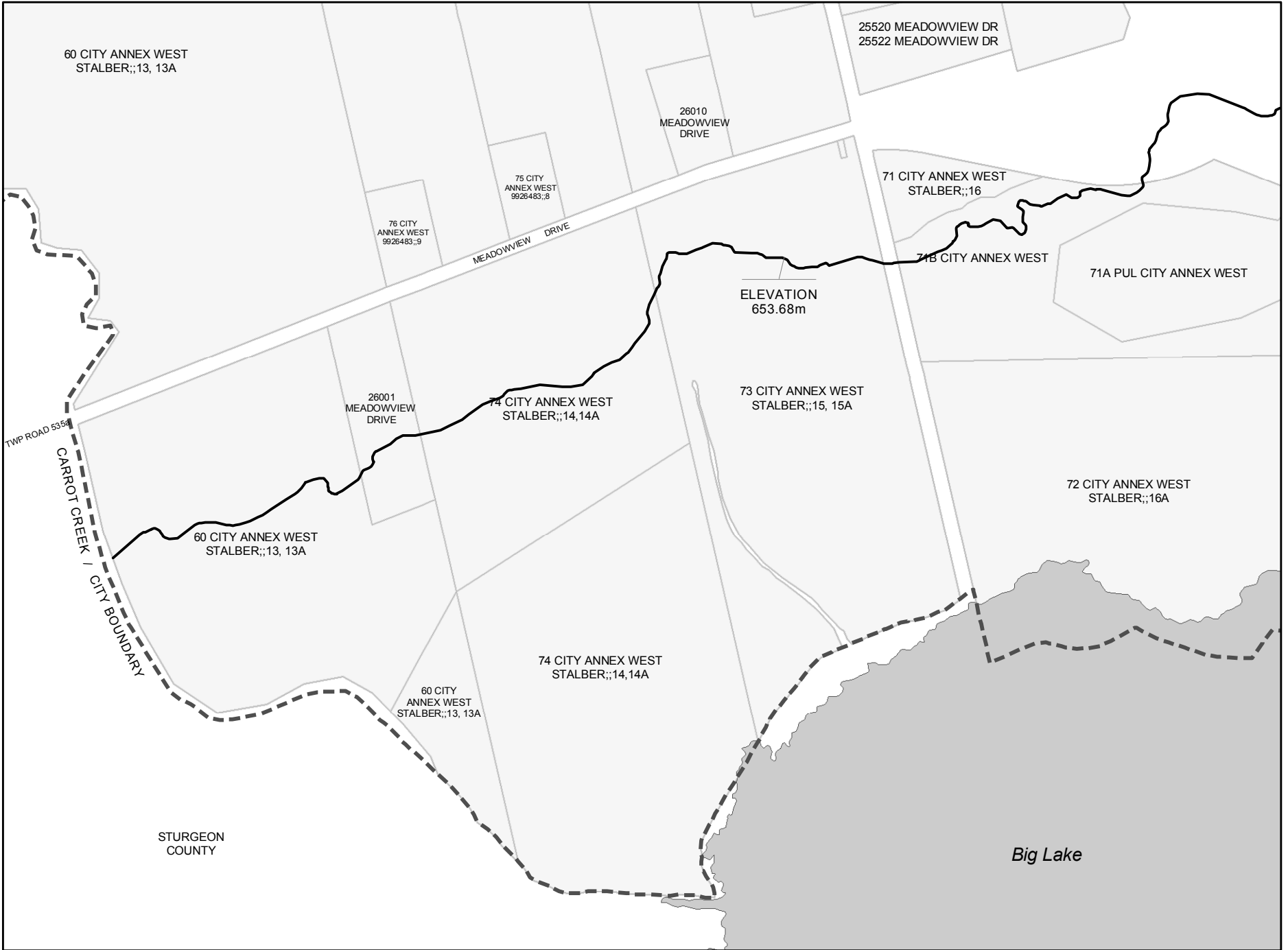

Schedule G



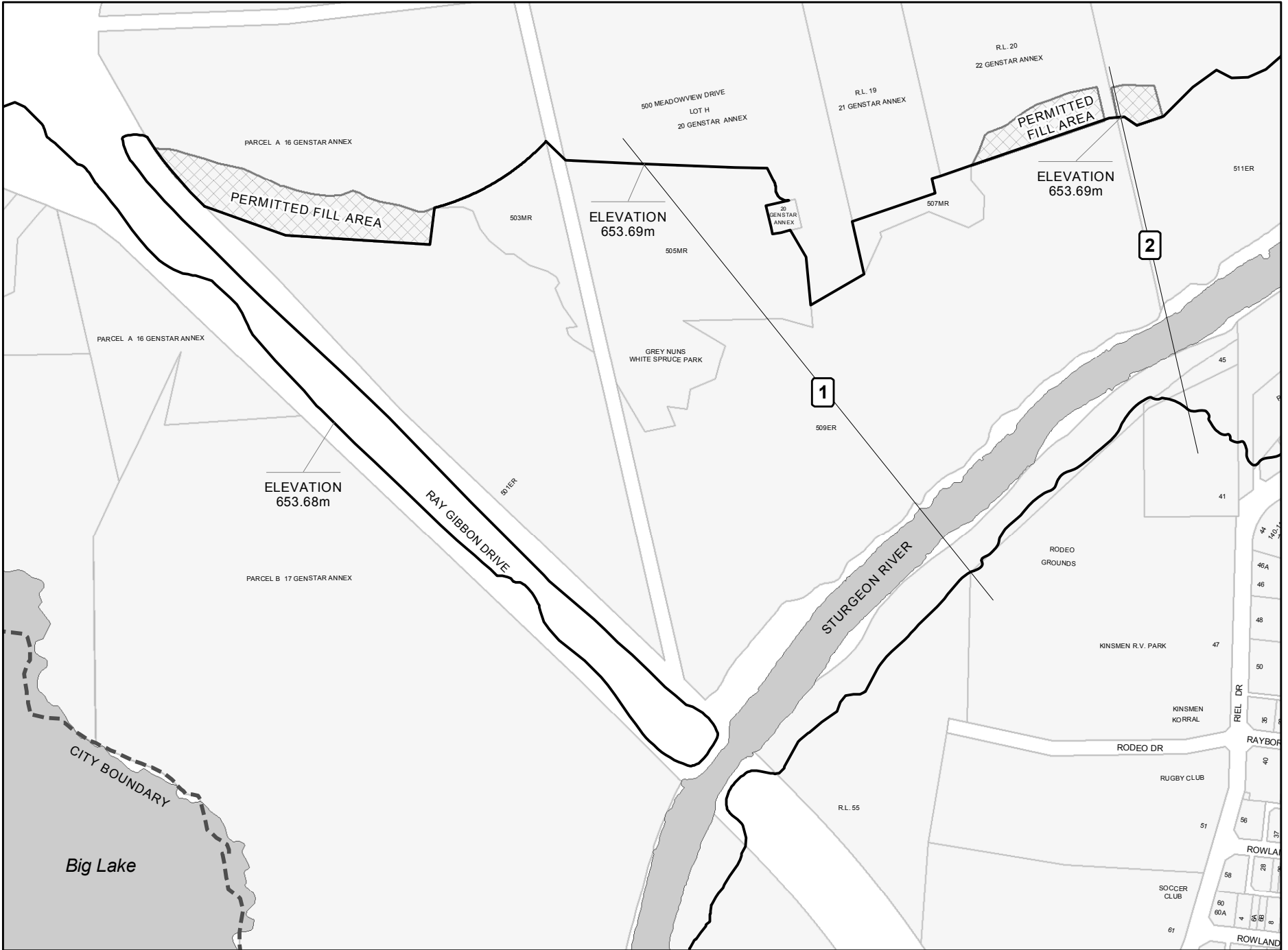

Schedule G





Schedule G



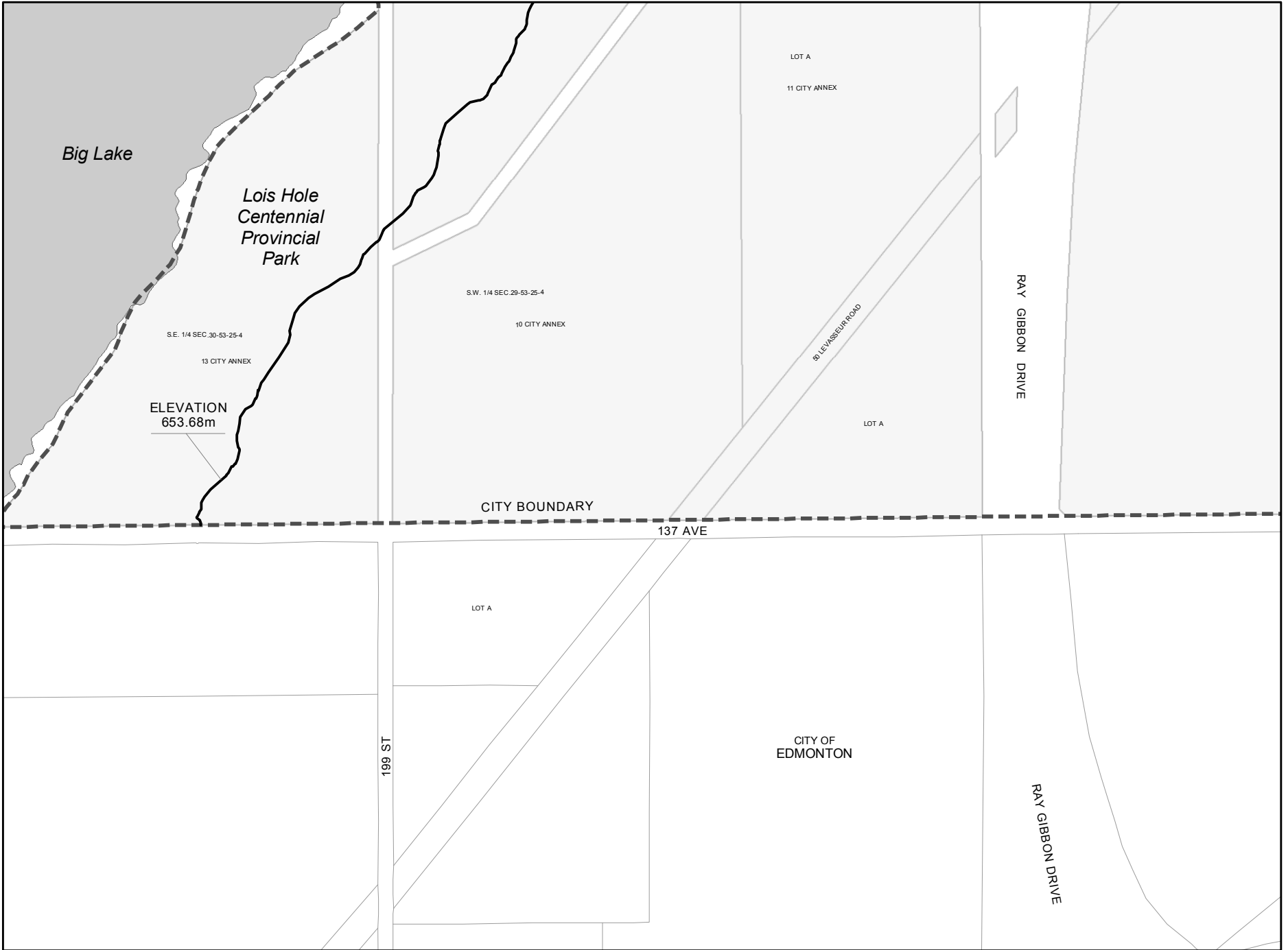

Schedule G



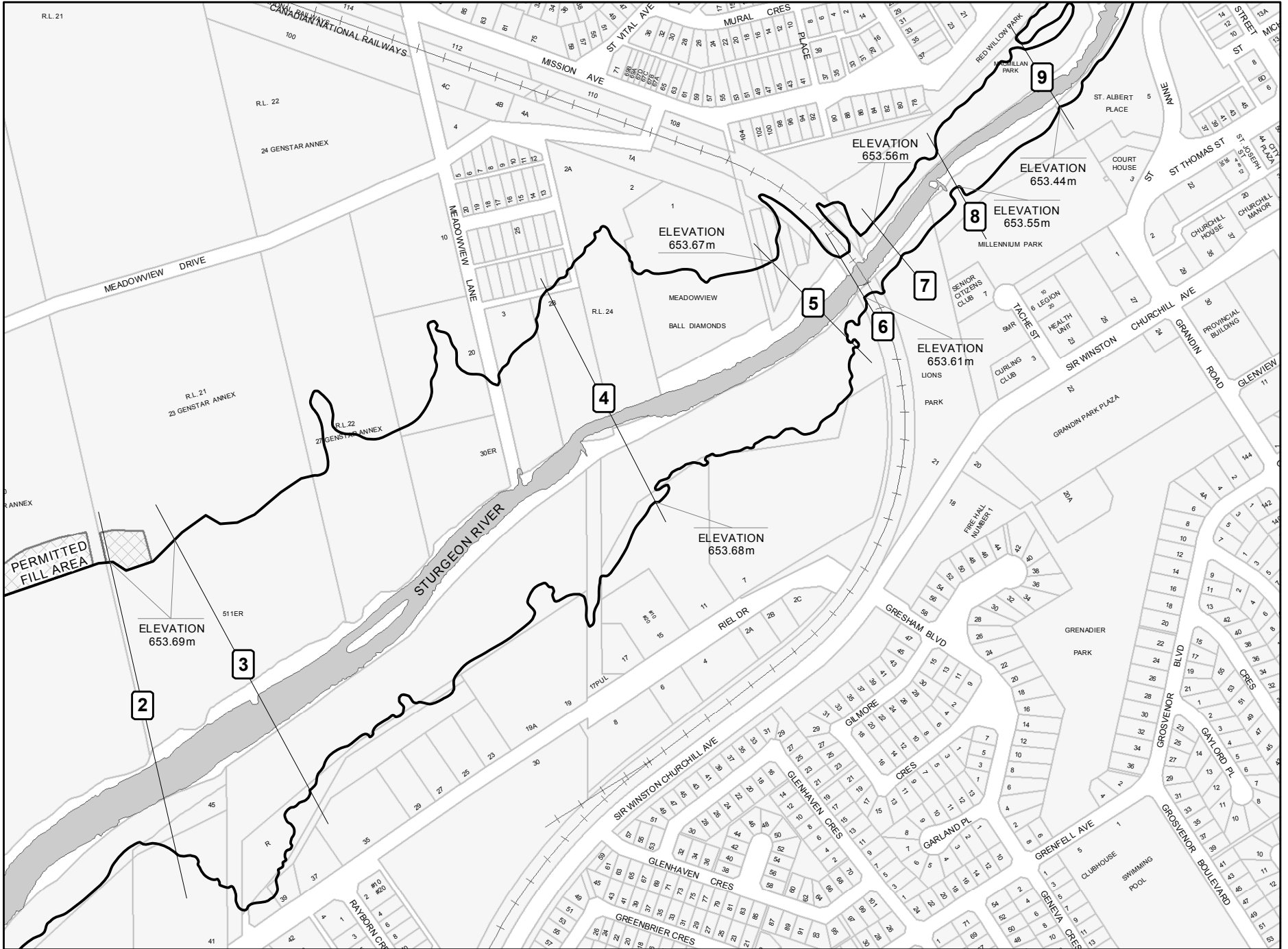

Schedule G



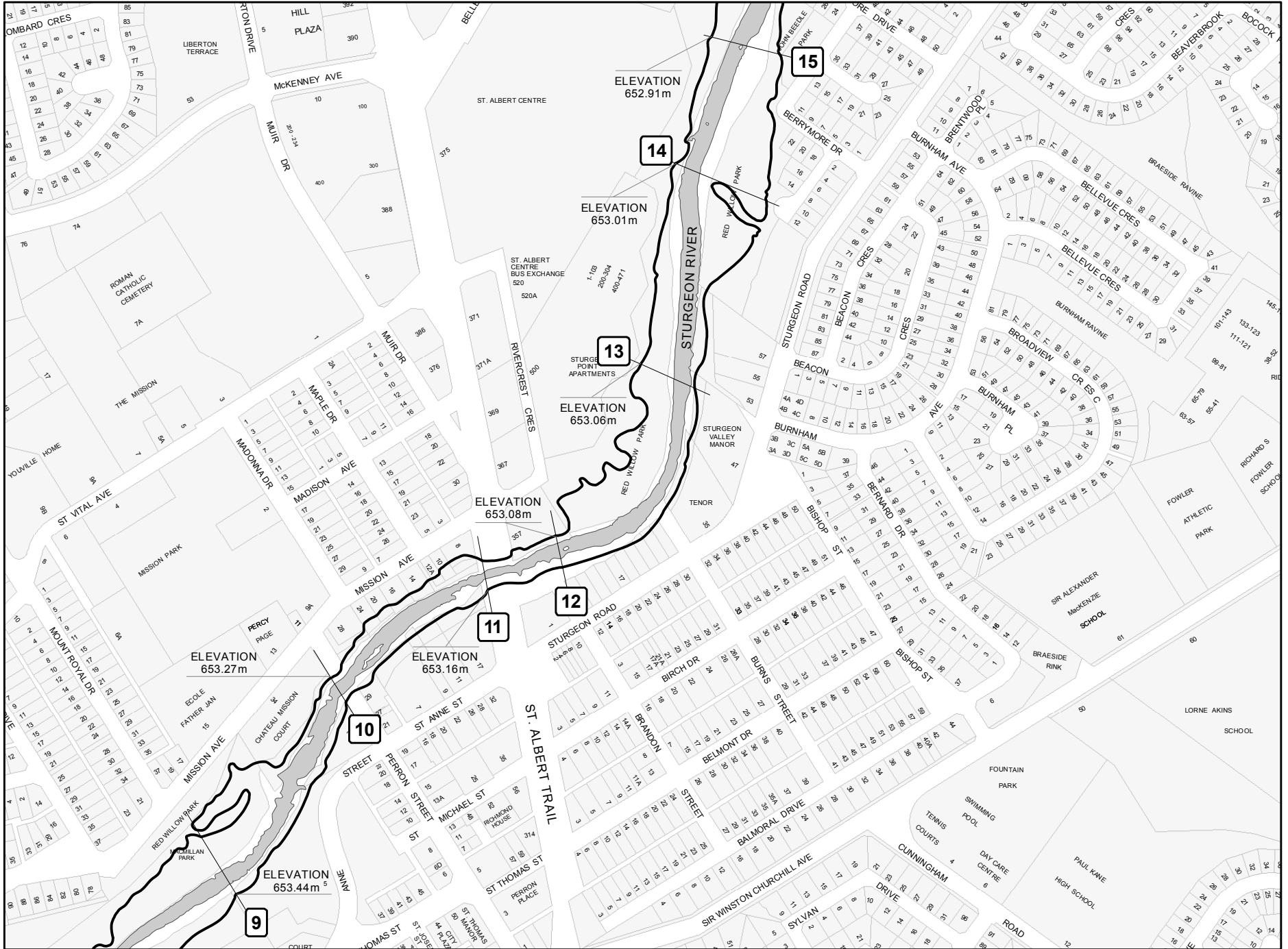

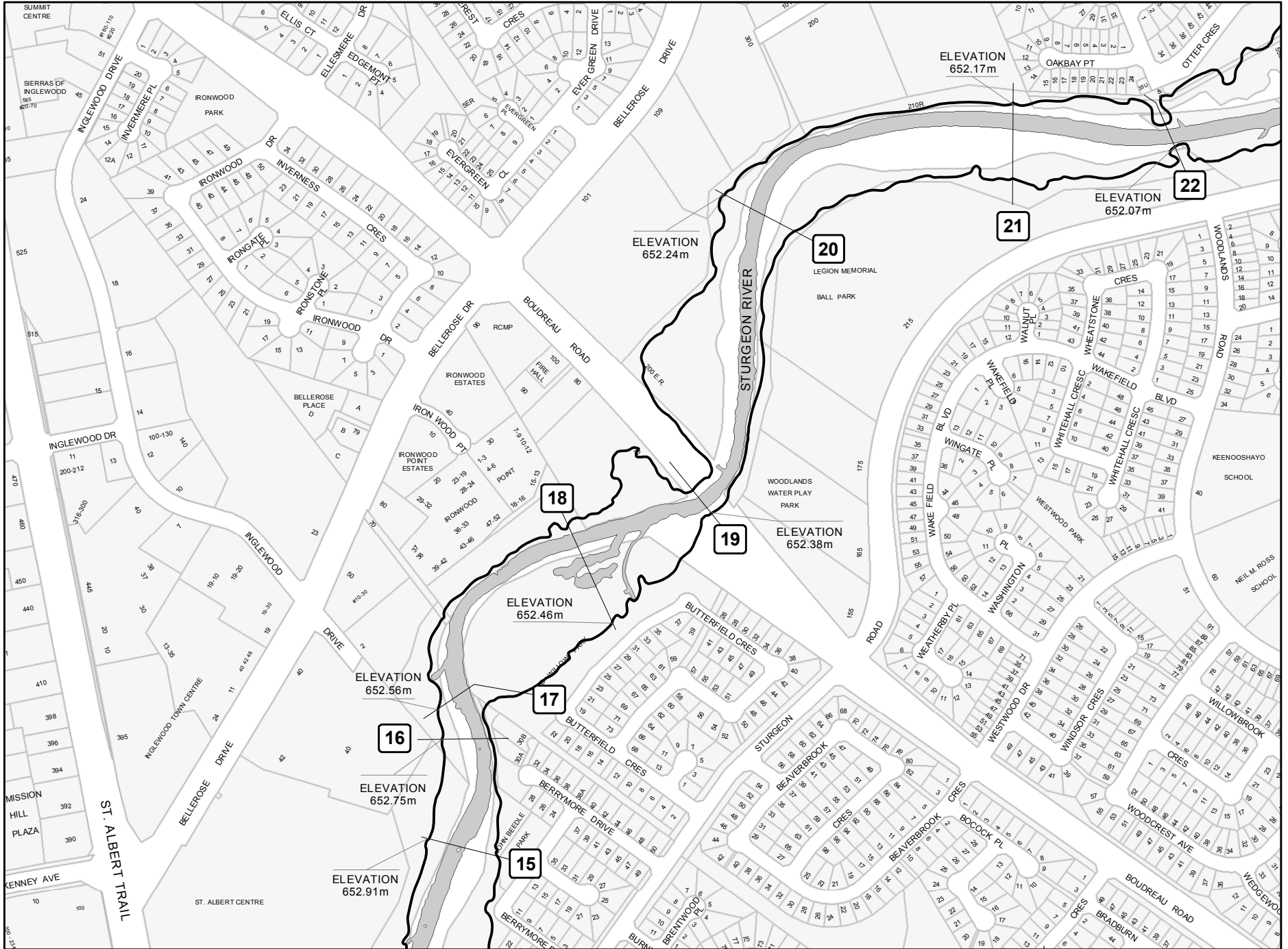

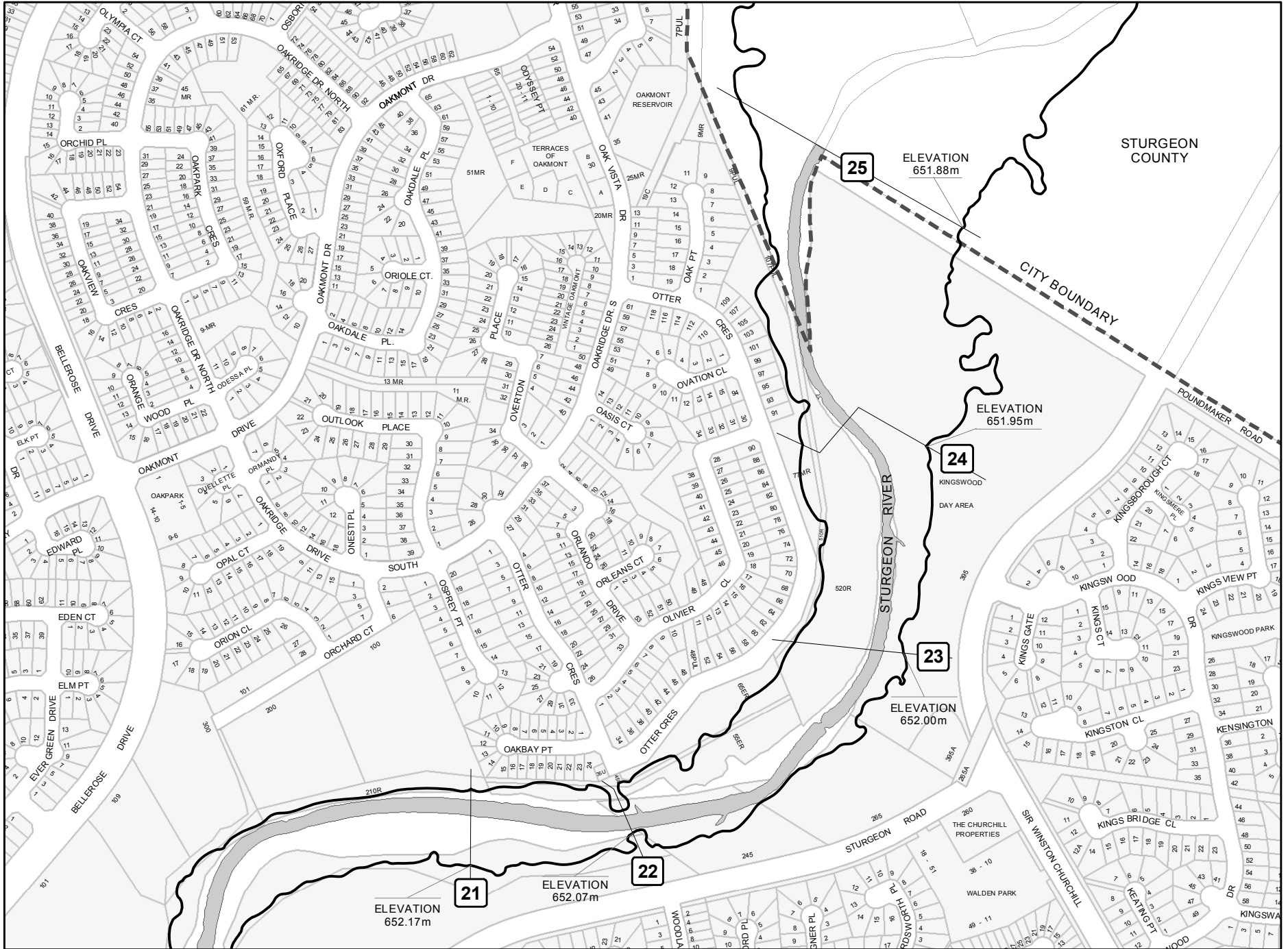

G:\MAPS\FloodMapping\2011\Schedule G\MAP-08-Oakmont & Kingswood.mxd

0 50 100 200 300 400 metres



### Designated Flood Line Map

MAP 08

Schedule G

This page left intentionally blank for printing purposes.